



METRIC CENTER BASKET TROFFER with Optional Air Return INSTALLATION GUIDE

OVERVIEW

TOOLS REQUIRED (NOT INCLUDED)

- Wiring supplies as per national and local electrical codes
- Hardware/tools required to mount to structure (field provided)

INSTRUCTIONS FOR THE FOLLOWING FIXTURES

Order	Model
R35408	RENO-2060CTF-UNV/347-MWMCCT

IMPORTANT

- Instructions do not cover all details and all possible product configurations. Do not restrict luminaire ventilation.
- Ensure LED luminaire is not covered with material that will prevent convection or conduction cooling. Ensure LED luminaire has the correct polarity before installation
- Avoid exposing wiring to metal edges and sharp objects.

WARNING & SAFETY

- To avoid electric shock: Be certain electrical power is OFF before and during installation and maintenance. Luminaire must be supplied by a wiring system with an equipment grounding conductor. To avoid burning hands: Make sure lens and housing are cool when performing maintenance.
- To avoid product degradation: Make sure the wire supply voltage is the same as the luminaire supply. Use proper supply wiring as specified on the luminaire nameplate.
- Avoid use in environments containing sulfur, chlorine, or other halides, methyl acetate or ethyl acetate, cyanoacrylates, glycol ethers, formaldehyde or butadiene.

FOR ADDITIONAL INFORMATION REQUIRED NOT COVERED IN THIS DOCUMENT PLEASE CONTACT A LOCAL REPRESENTATIVE!

- Maintenance: Perform visual, electrical, and mechanical inspections on a regular basis. The environment and frequency of use should determine this. However, it is recommended that checks be made at least once a year. Electrically check to make sure that all connections are clean and tight. Mechanically check that all parts are properly assembled.

INSTALLATION INSTRUCTIONS WIRING DIAGRAM

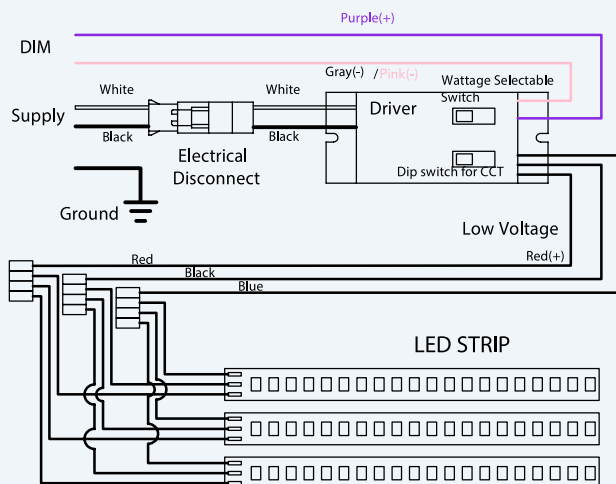

■ Dip switch for CCT And Wattage Selectable Switch

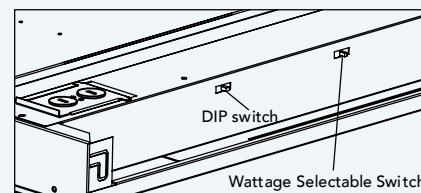

■ Dimension

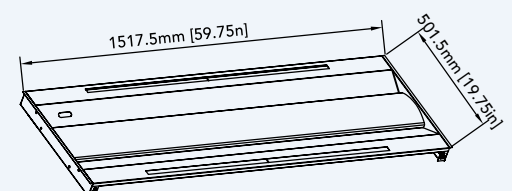

INSTALLATION INSTRUCTIONS

#	Step
1	Knock out the vent opening if needed, using a tool, as shown in the figure below.
2	If a sensor is needed, use a tool to knock out the sensor knockout and install the sensor onto the fixture as shown in the diagram to the right.

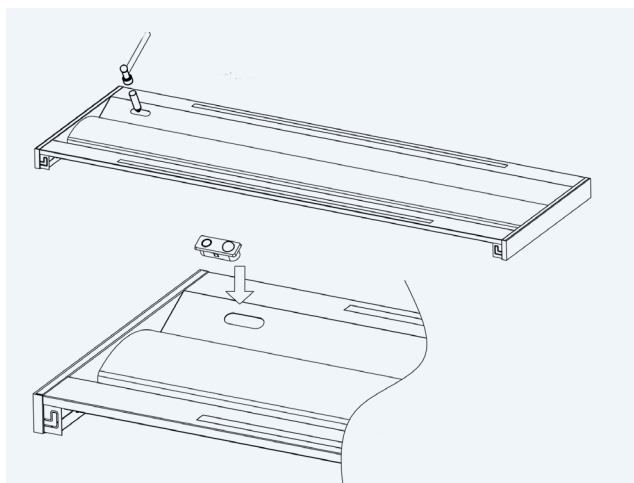
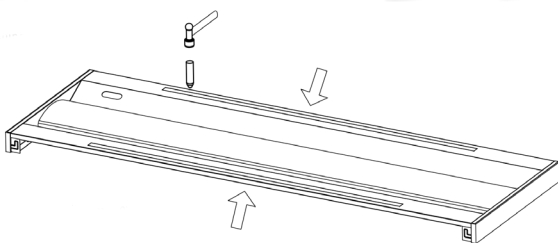

#	Step
3	Lift up the troffer on its sides through the grid and align it with the T-Bar grid.
4	Bend the fixture's T-Grid clips on all four corners and secure the Troffer in to the ceiling grid. Use safety cables for additional support as per local/national building code.

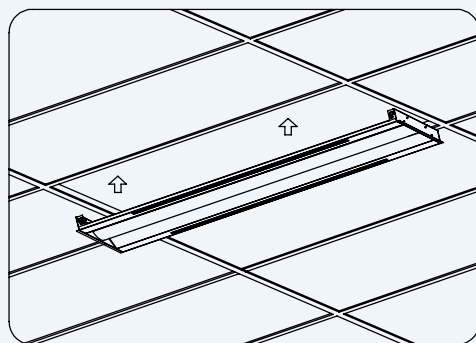

#	Step
5	Place and secure the troffer into the ceiling grid. Ensure safety cable is connected to the safety hook.

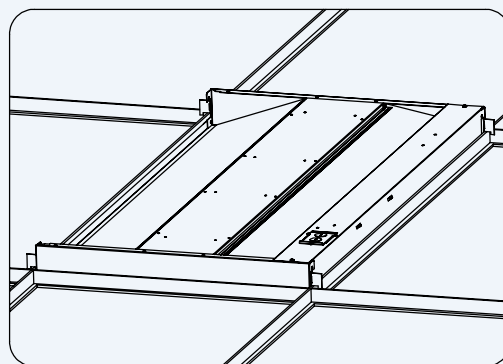

INSTALLATION INSTRUCTIONS

#	Step
6	Feed the building's supply wires into the fixture via access plate and secure the connections using wire nuts. Connect the purple and pink wires correctly if 0-10V dimming is being used.

